

SPIDER WEB SYSTEMS

a presentation by
W H Inmon

in the beginning there was paper tape



then there were punched cards

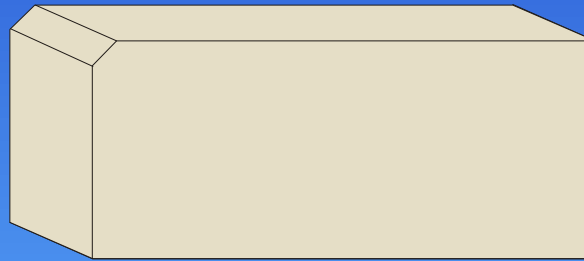

then there was
magnetic tape

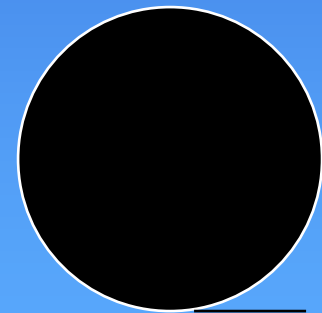

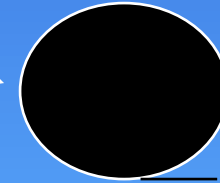
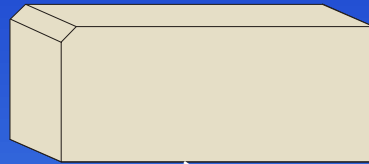

then came
batch processing
and master files

and then came reports

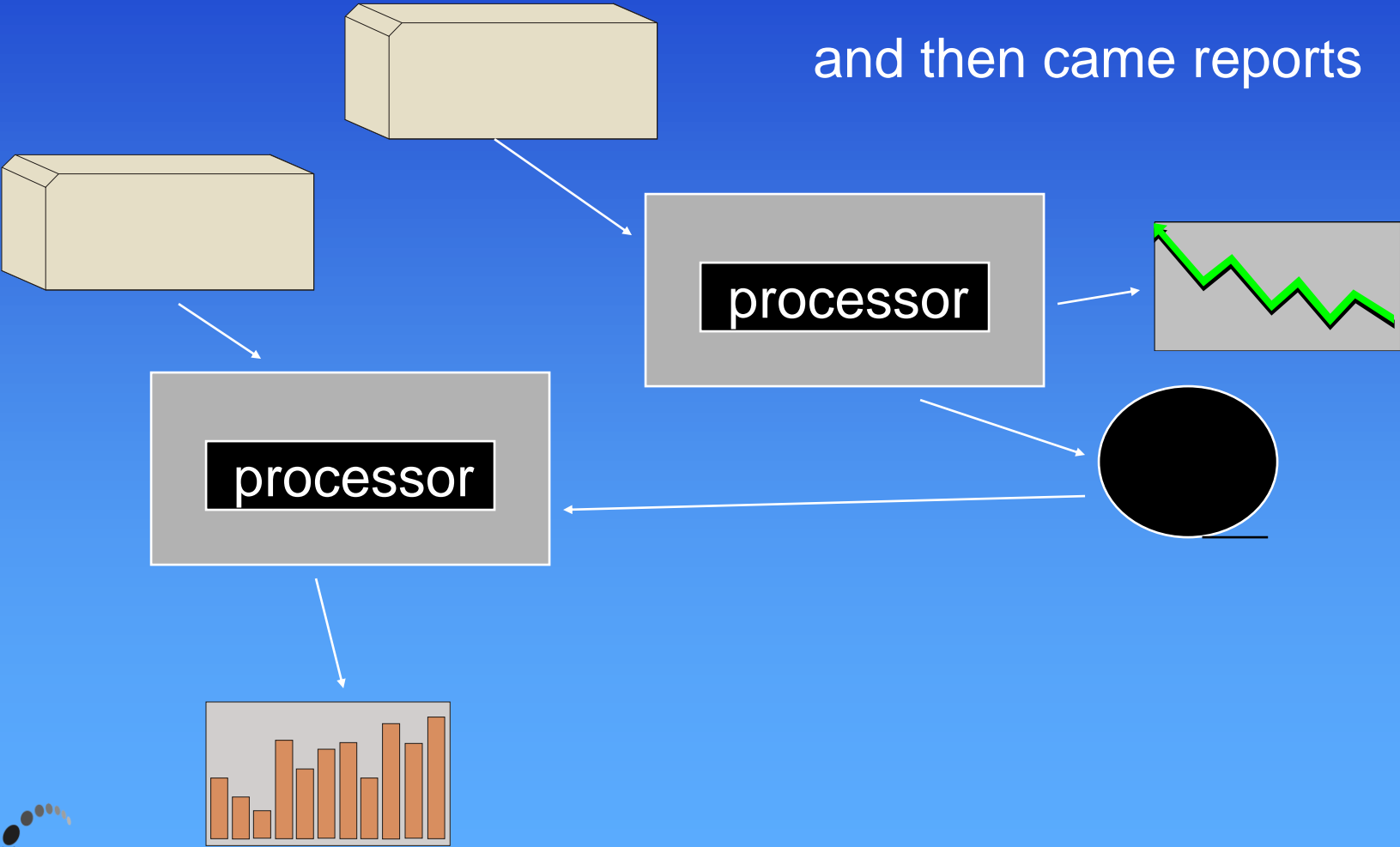

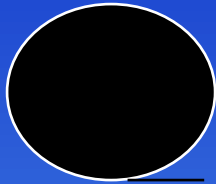

but it turned out that there were major problems with magnetic tape as the predominant storage media

- oxide fell off the tapes
- to get to 1 record you had to access 100% of all records



soon magnetic disk storage replaced disk storage

with disk storage, data could be accessed directly

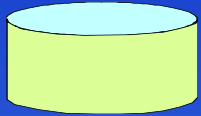

and with the advent of dbms,
online applications were born



soon online applications
sprang up everywhere

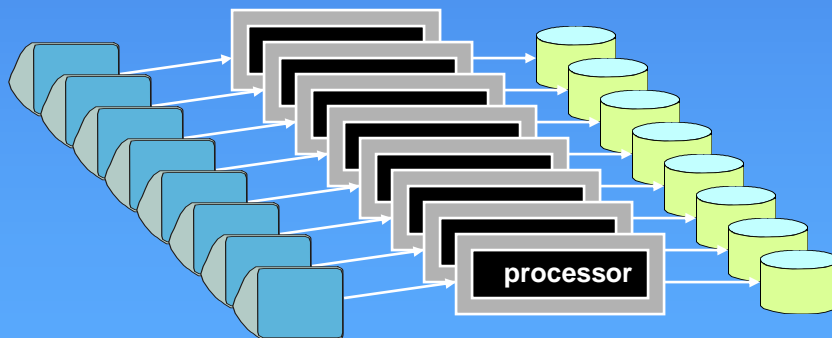

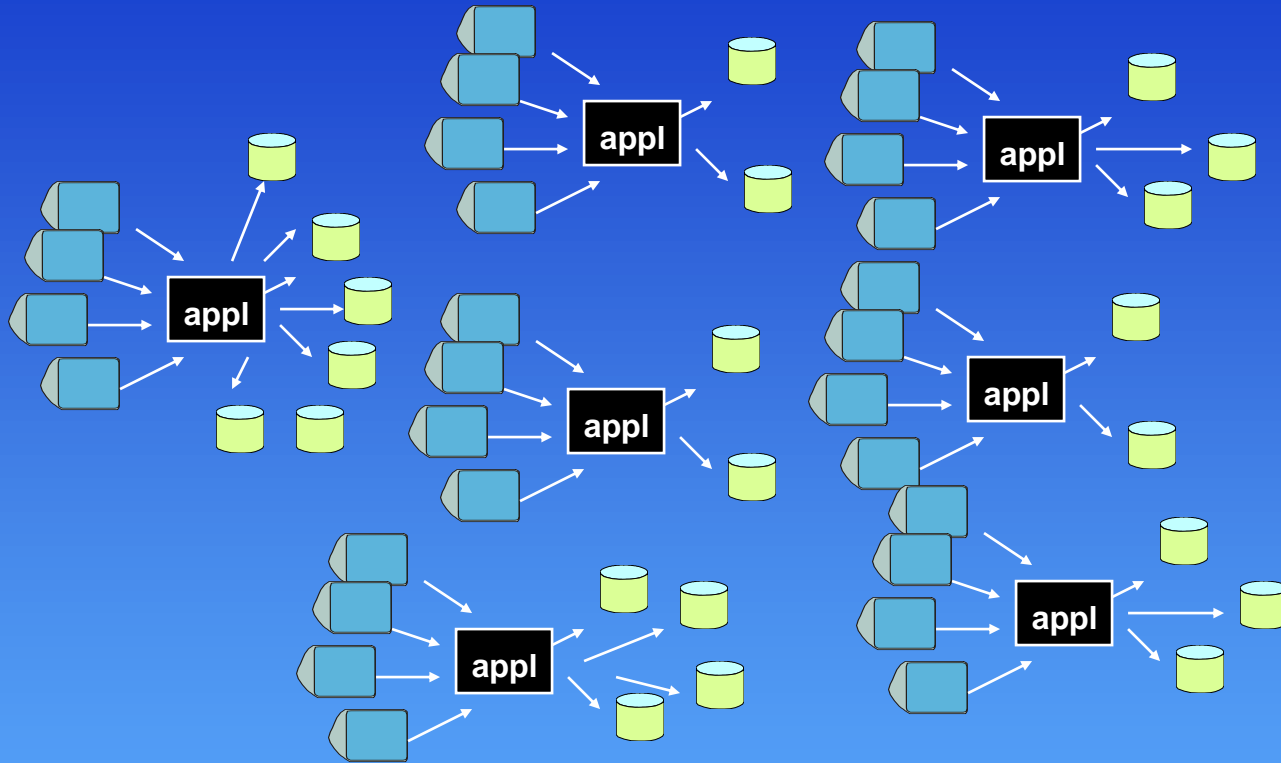

and for a while end users were happy

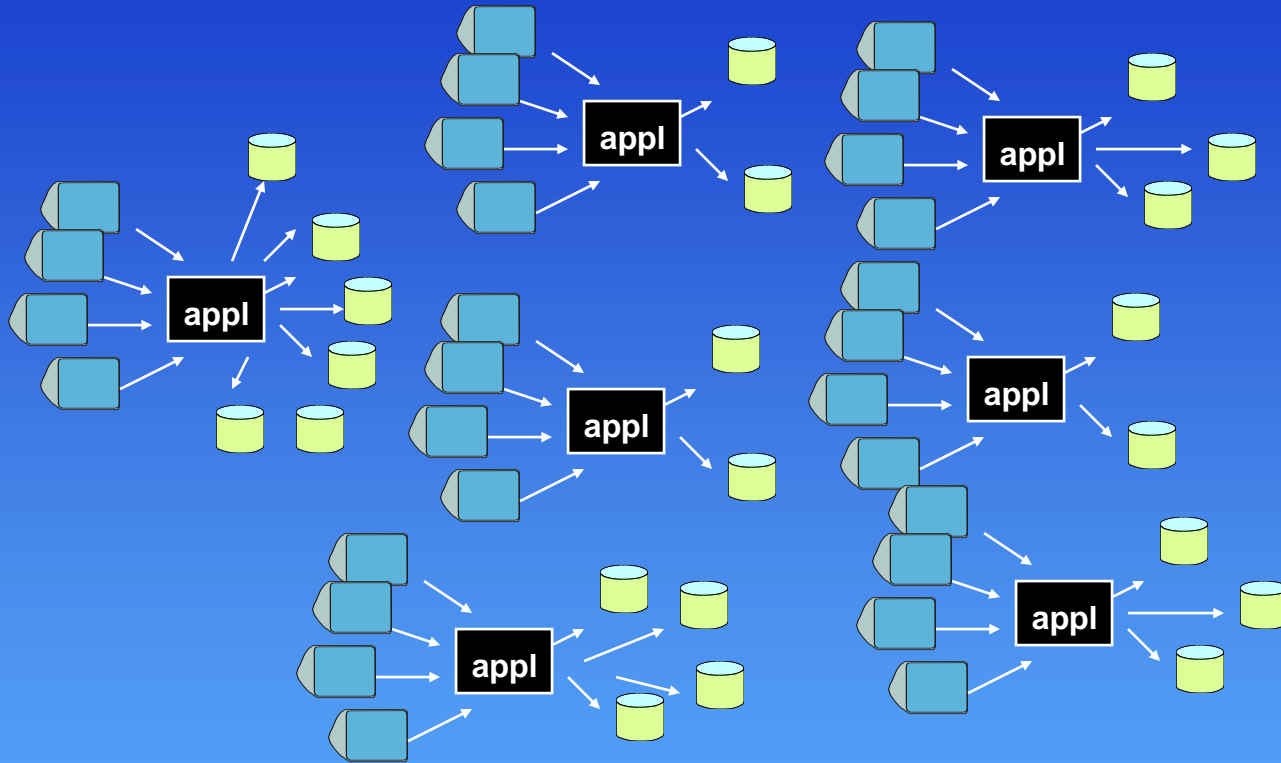

but soon it became obvious that data in one application was needed in another application

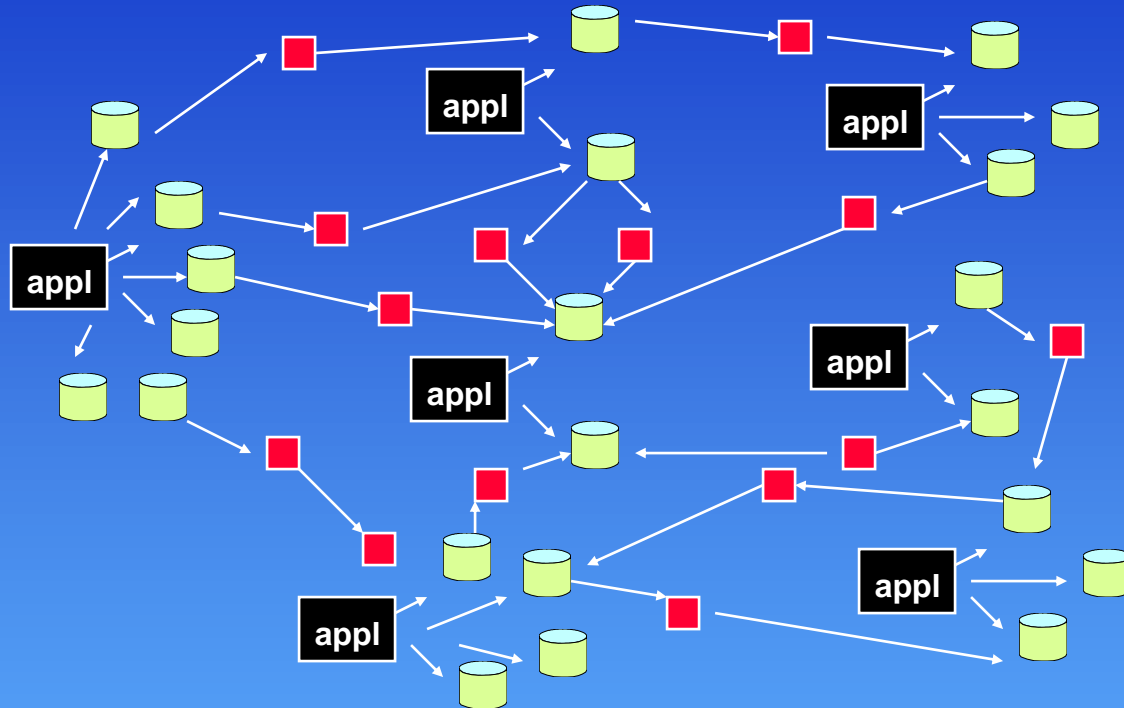

and soon individual elements of data began to be passed among applications

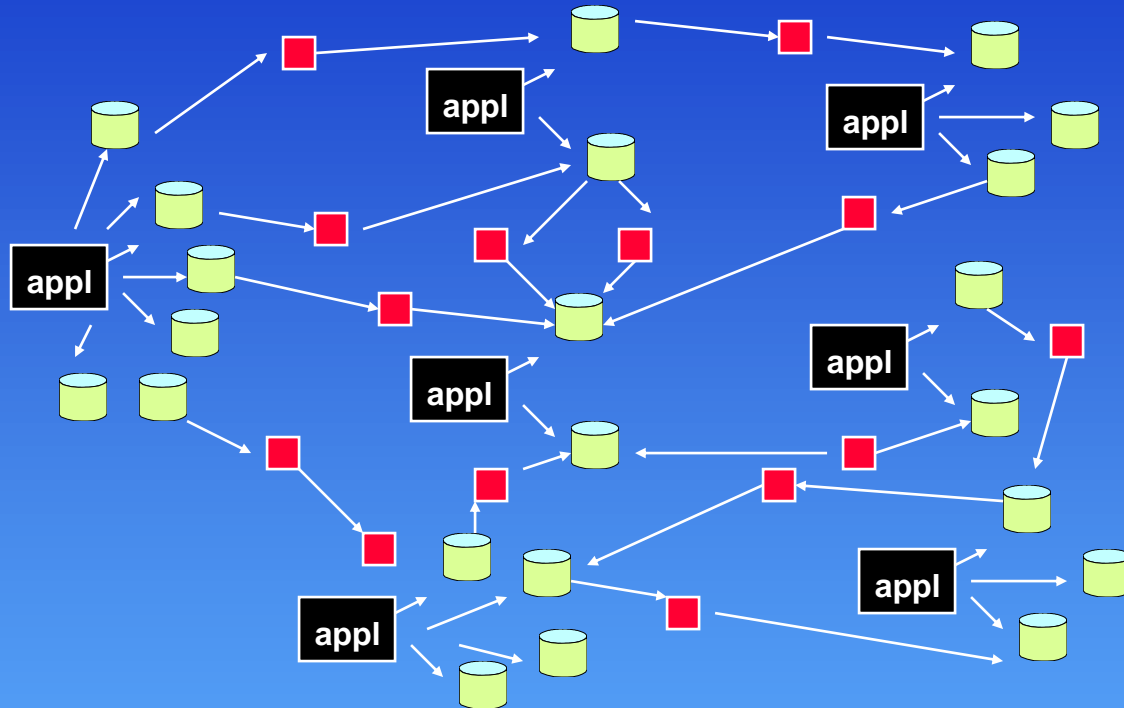

but through all of this the end user was still not satisfied

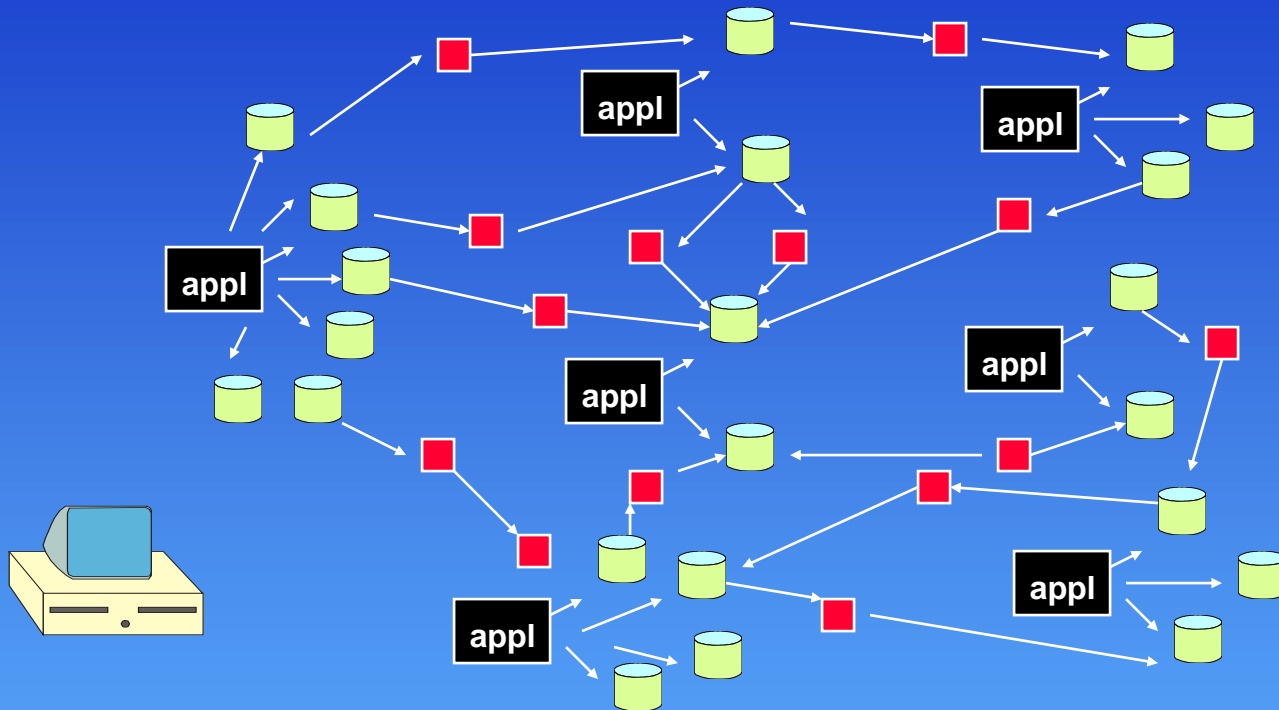

it was suggested that the end user could take his/her destiny in his/her own hands by taking data and using a pc

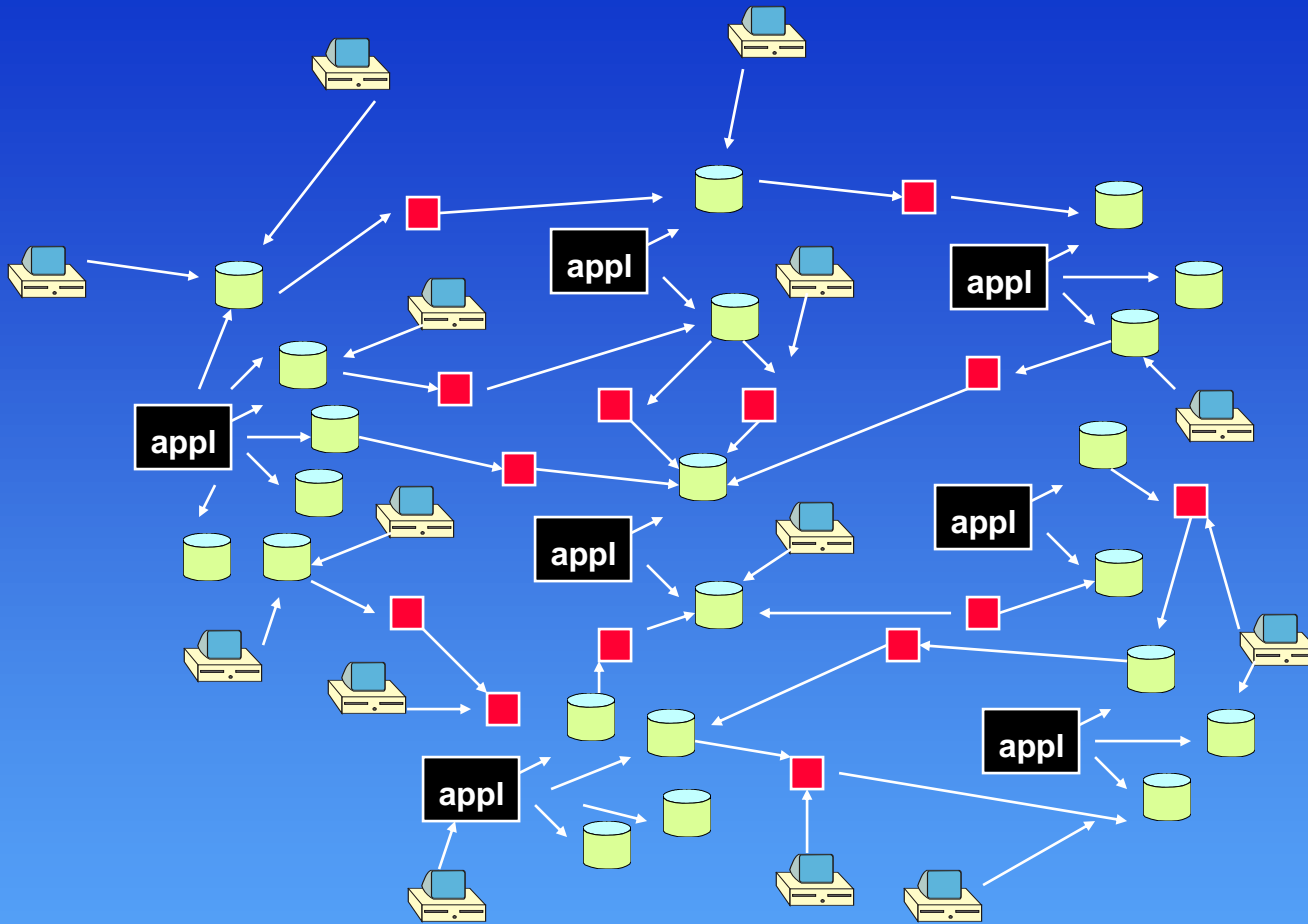

soon personal computers found their way into the information processing landscape

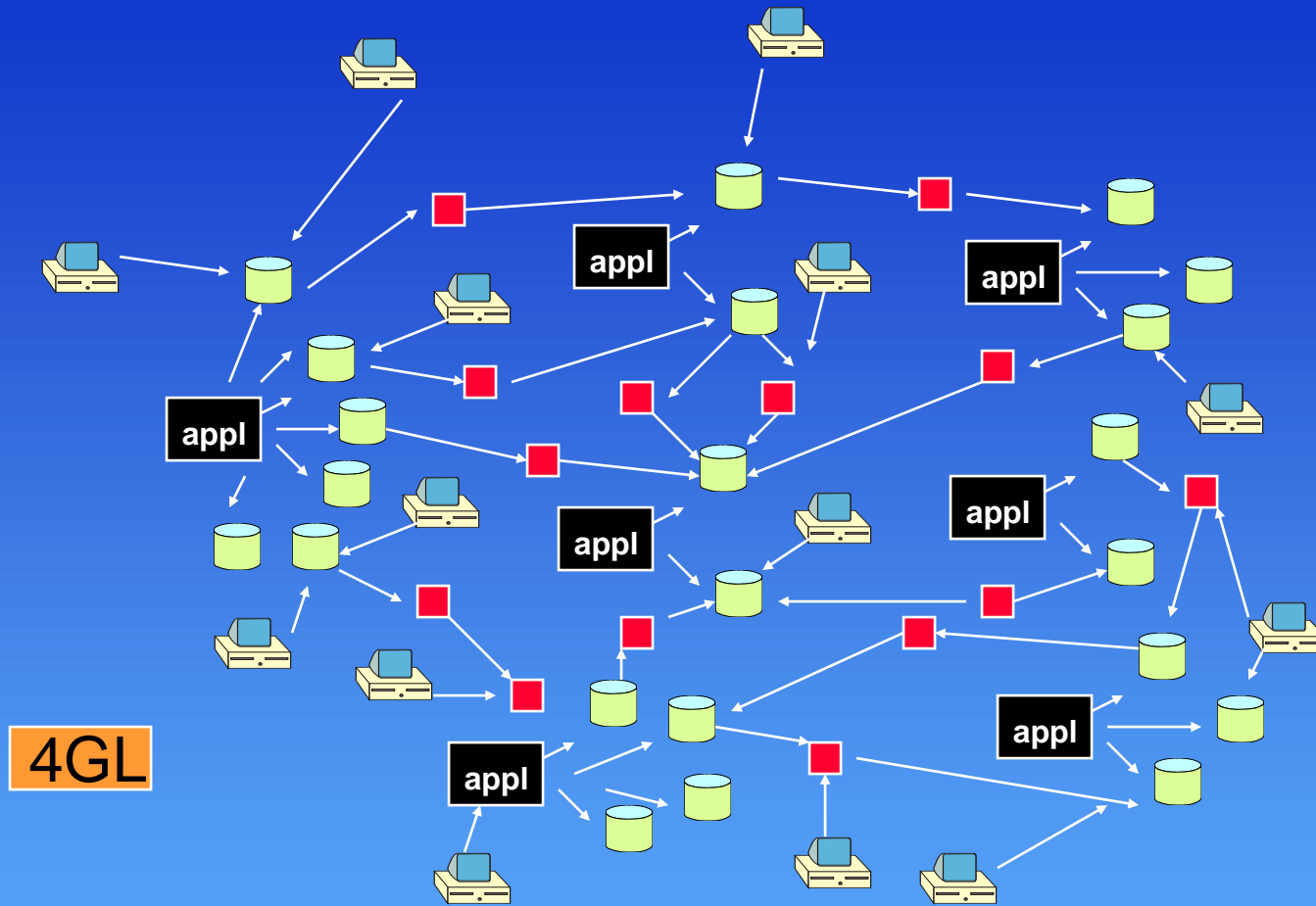

and at the corporate level it was suggested that the end users could take control with a 4GL

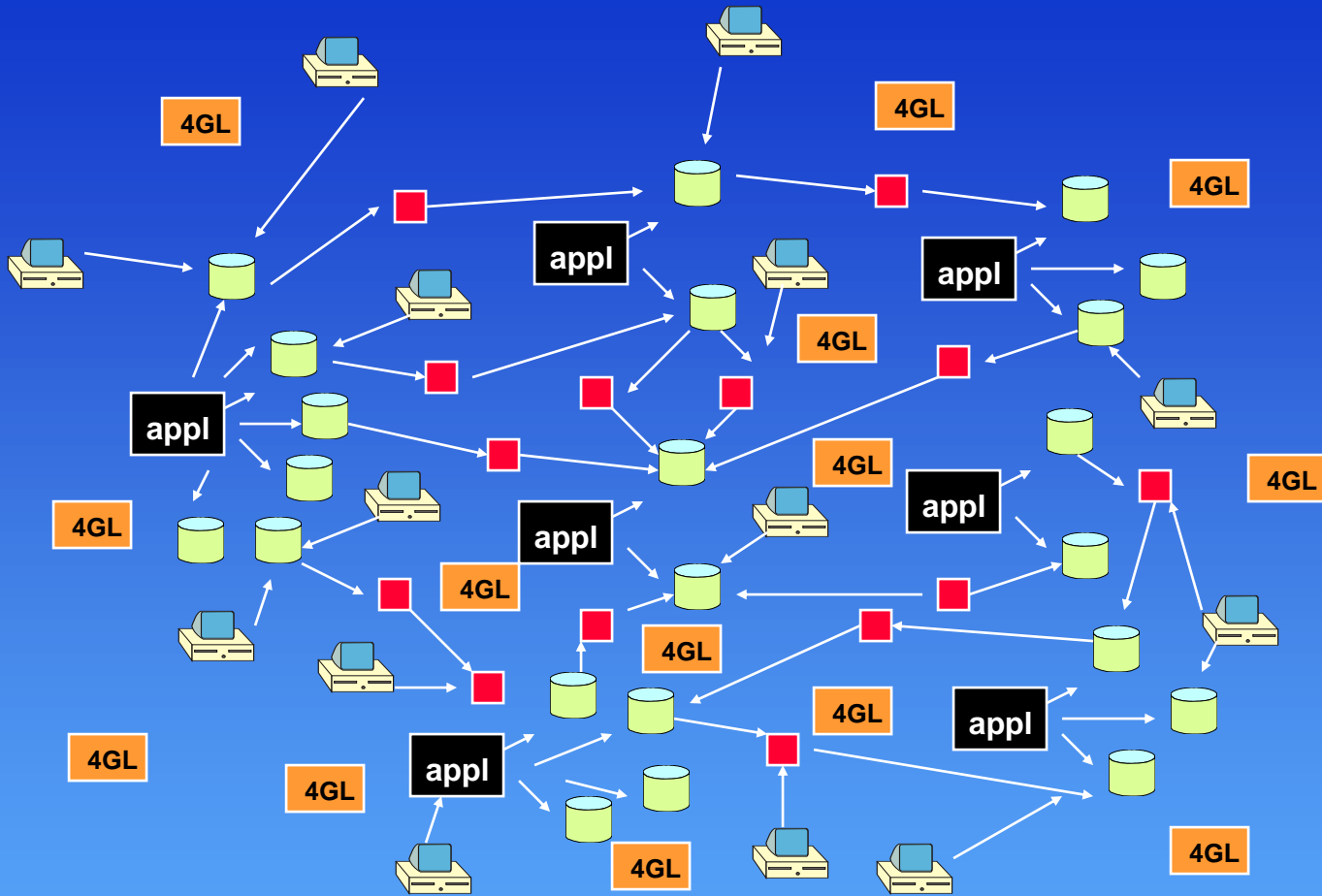

and soon 4GL's were everywhere

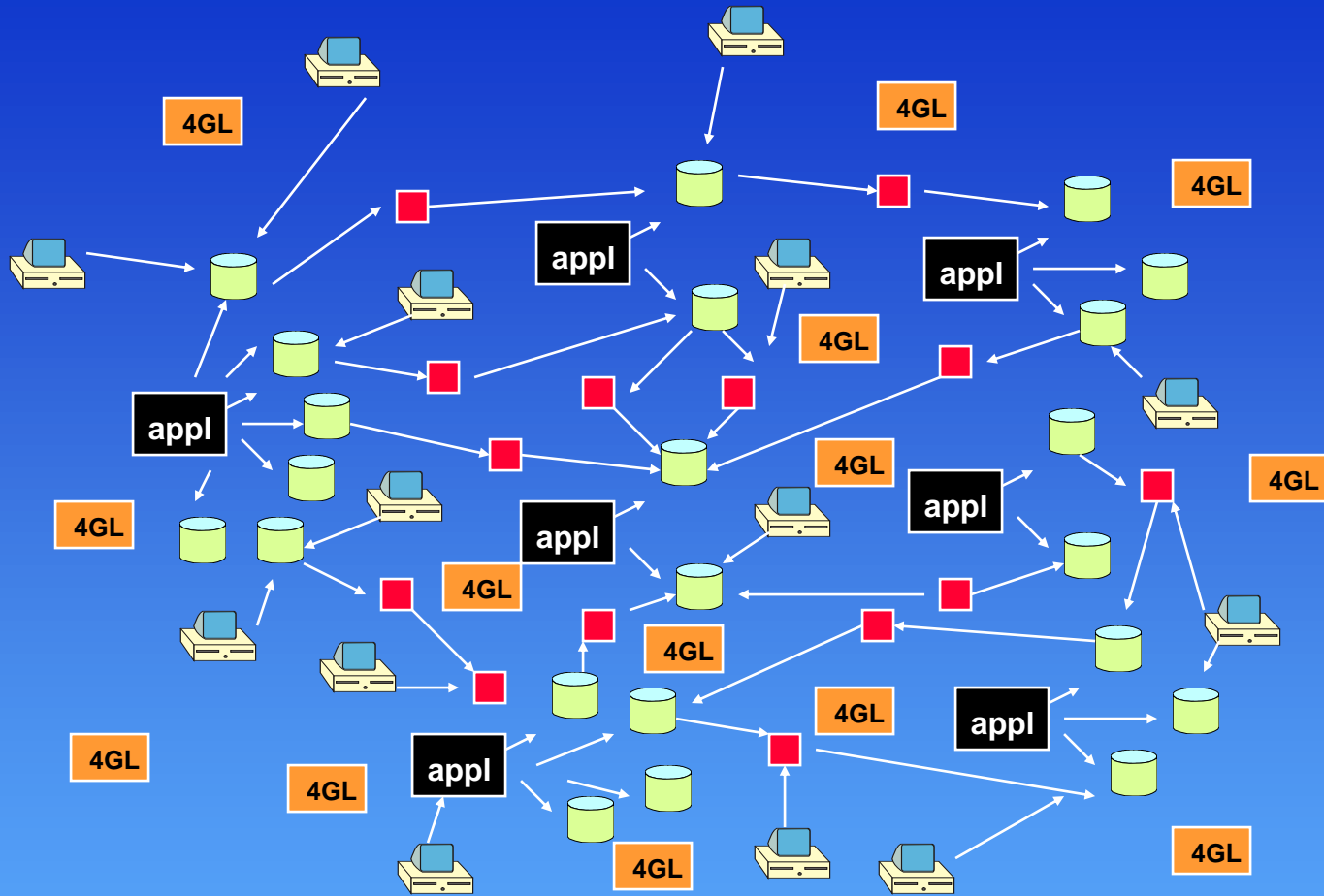

and soon it was discovered that 4GL processing needed data. Data was extracted by means of an extract program

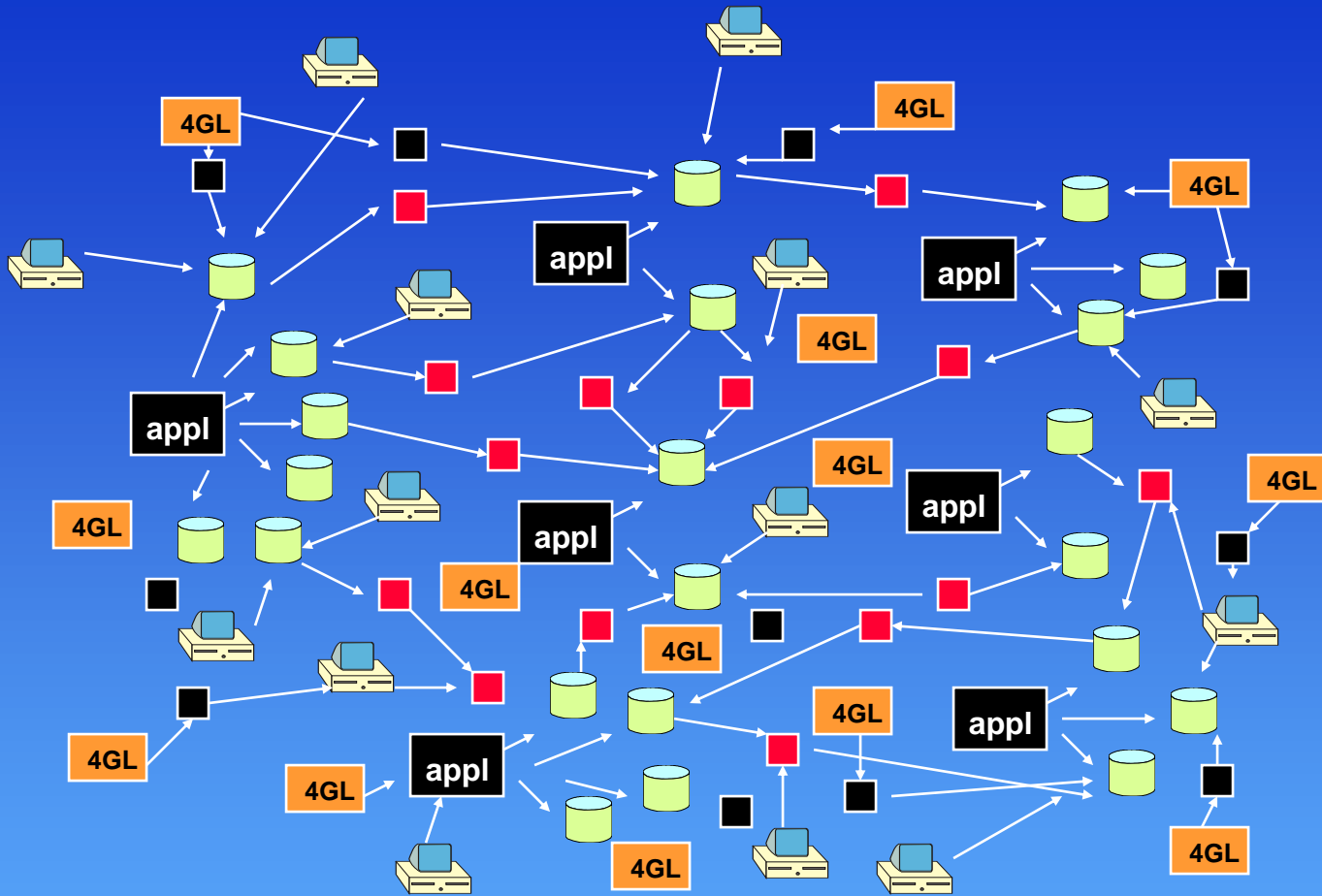

and one day the organization woke up and discovered it had a big mss on its hands – the spider web environment

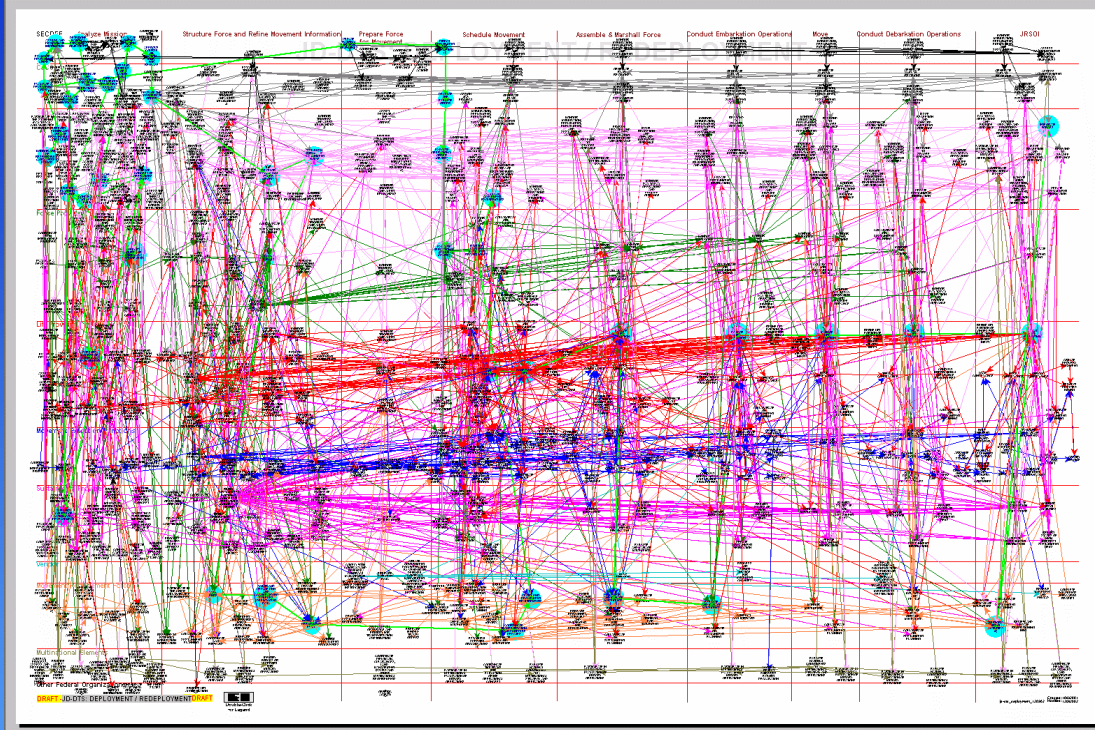

a real spider's web environment

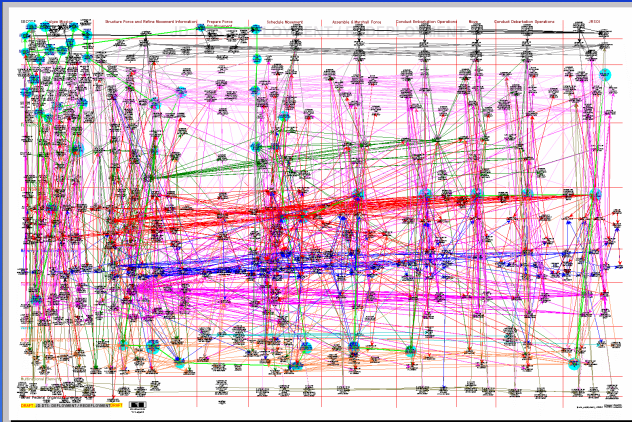

what's so bad about a spider web?

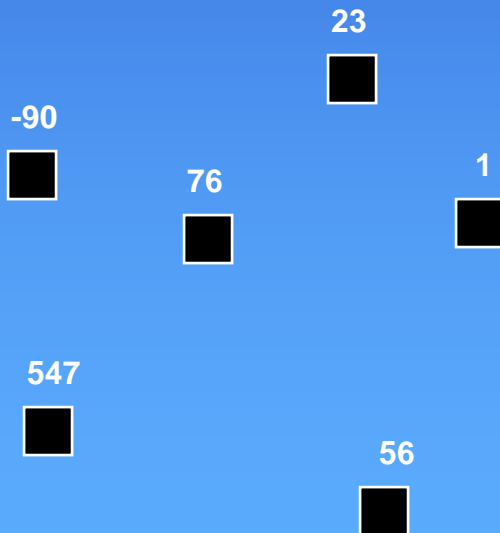

the same data is found everywhere – no one really knows what the correct value of data is

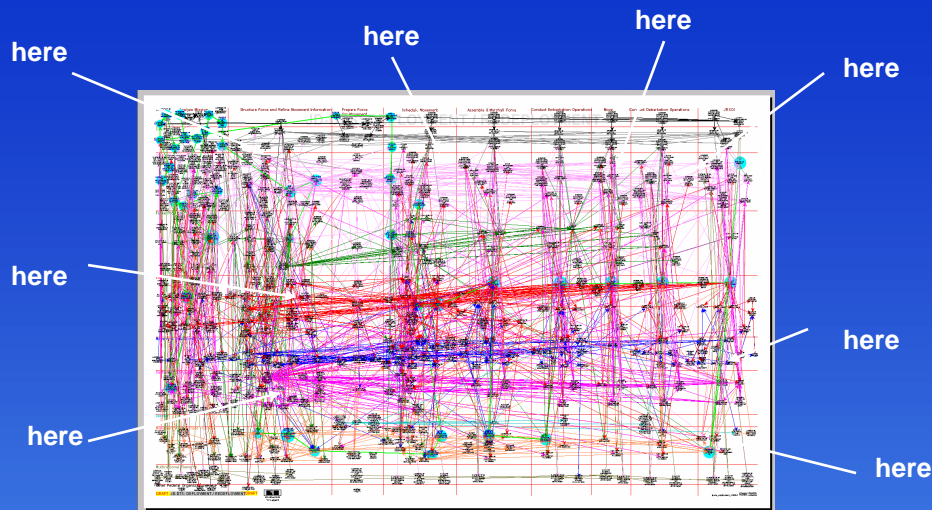

what's so bad about a spider web?

let's make a change to data

not only do we have to make changes everywhere,
we have to coordinate those changes as well

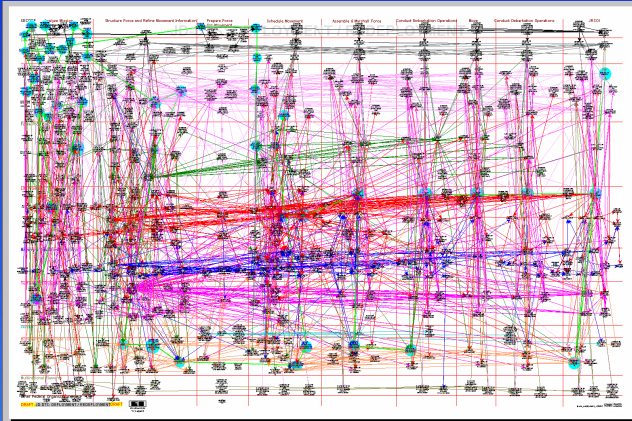

what's so bad about a spider web?

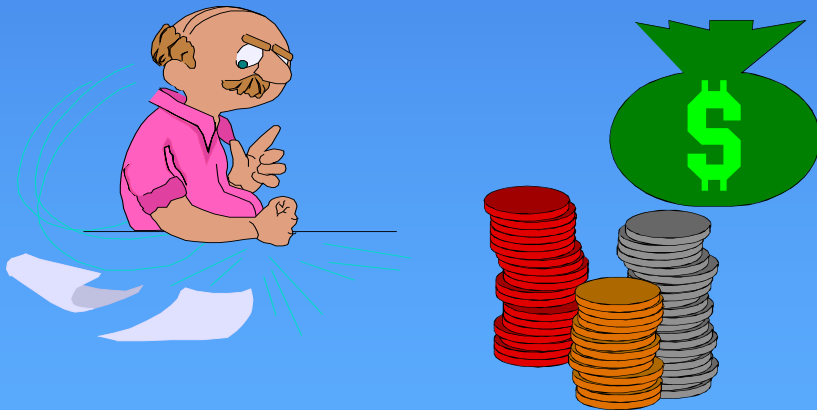

the cost of maintenance
spirals out of control

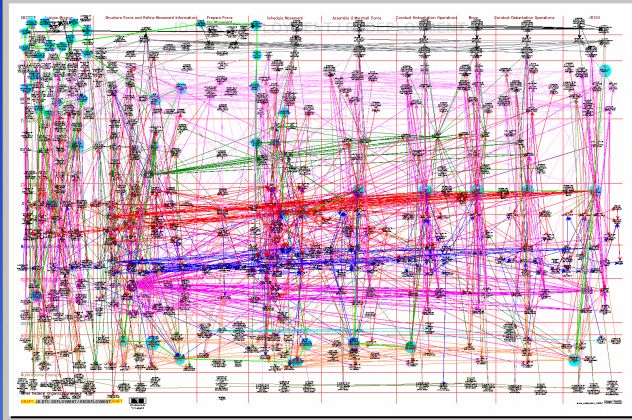

the spiders web environment is no foundation
for information systems to build on